

## Центробежни вентилатори тип KCF-N

- Центробежен вентилатор с изнесен двигател

### Приложение

- Центробежните вентилатори **KCF-N** са предназначени за изсмукване на чист или замърсен въздух от кухненски смукатели

### Конструкция

- Импелер с назад обърнати лопатки
- Стоманен корпус
- Щуцер за отвеждане на мазнини

### Опции

- Стандартно изпълнение с максимална температура на флуида: 80°C - (230V) / 120°C - (400V)
- KCF-N F4 - високотемпературно изпълнение с постоянна работна температура 200°C и 400°C/2h, съгласно EN 12101-3:2015 със сертификат 1404-CPR-3070

**Селекция**

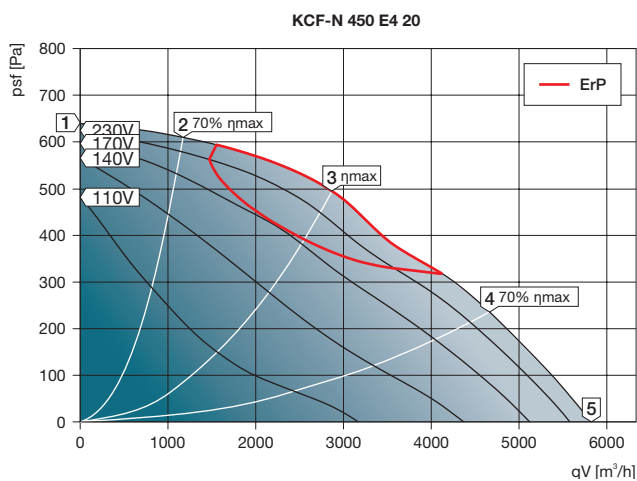
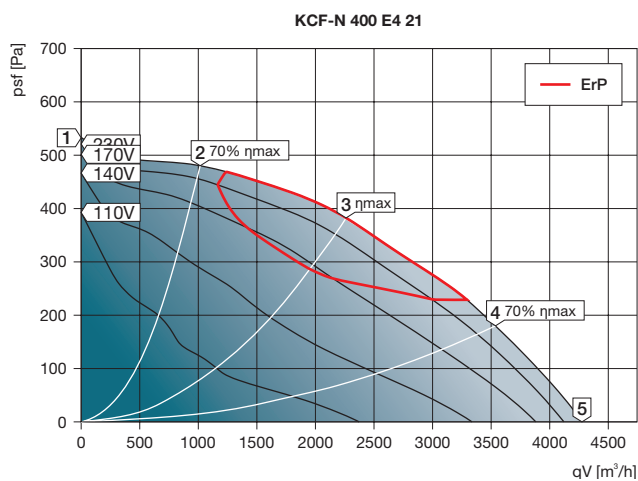
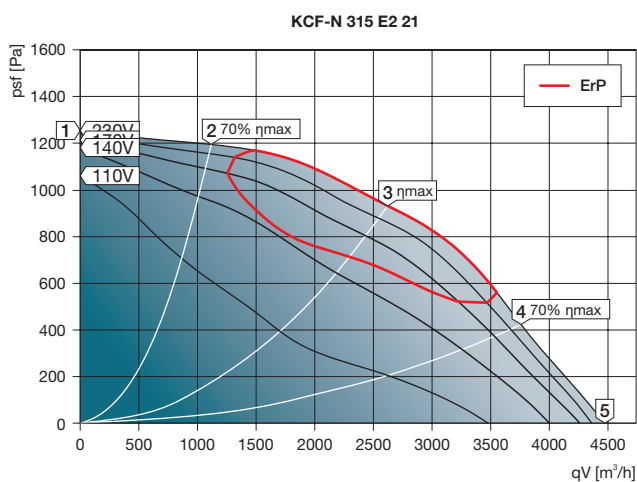
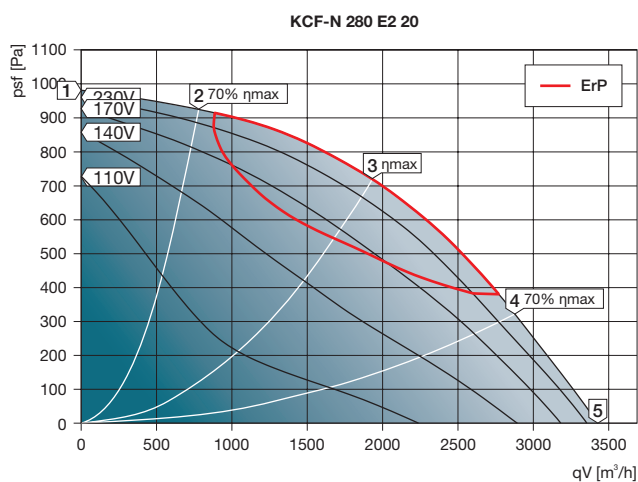
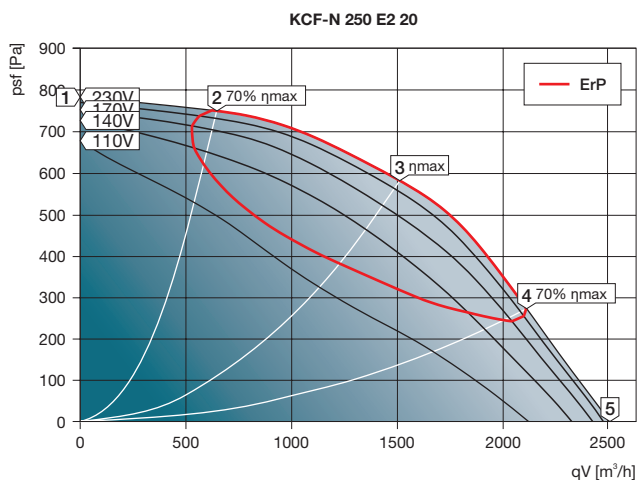
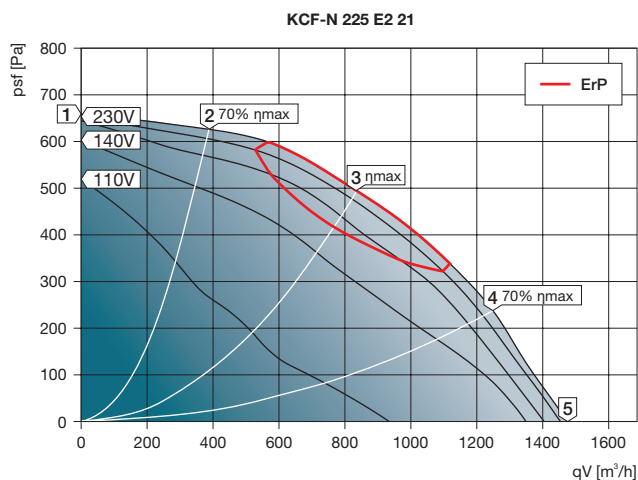

**Селекция**

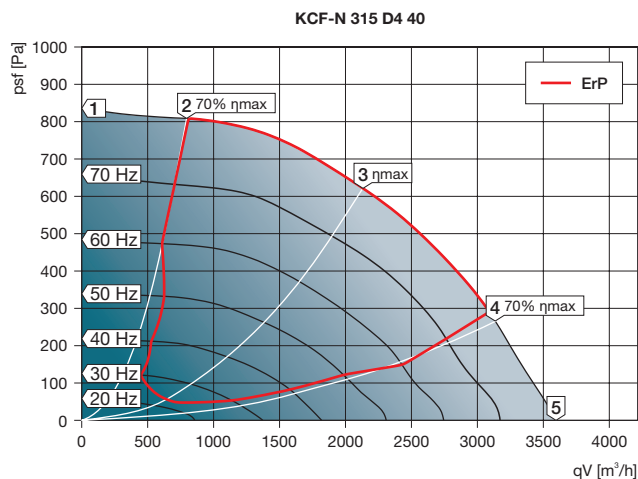
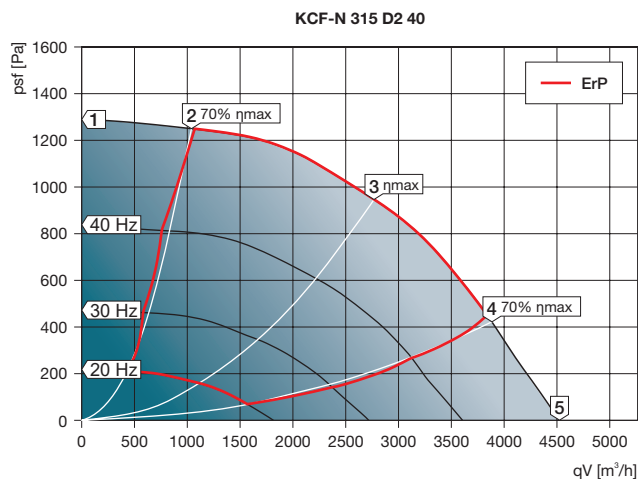
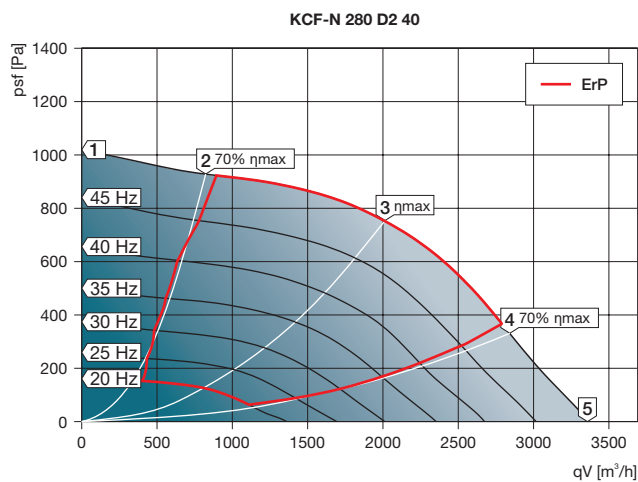
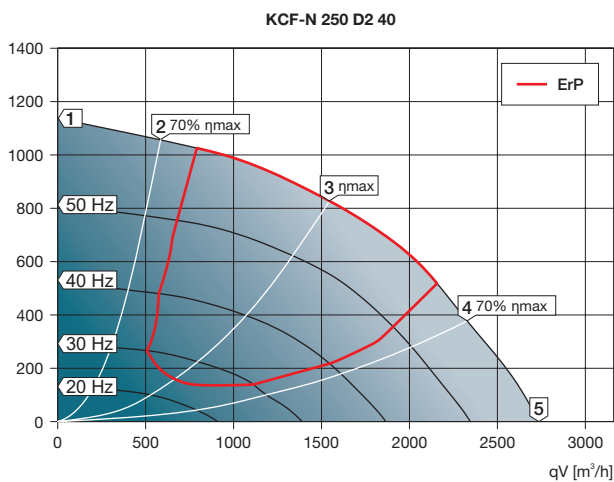
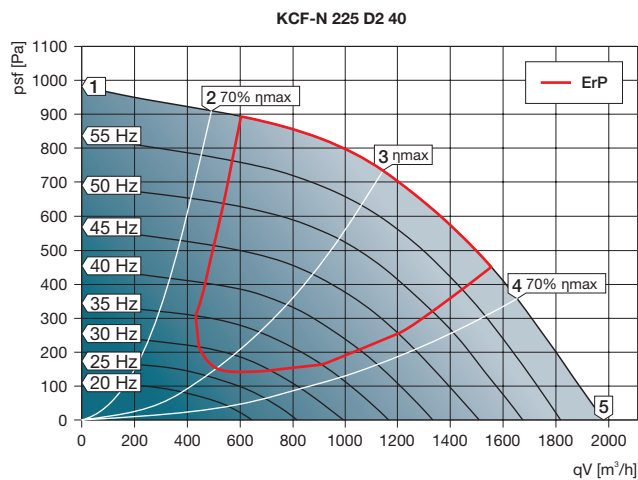
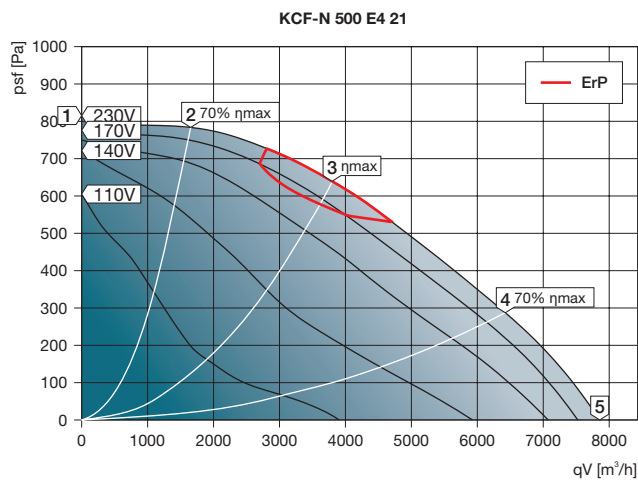

**Селекция**

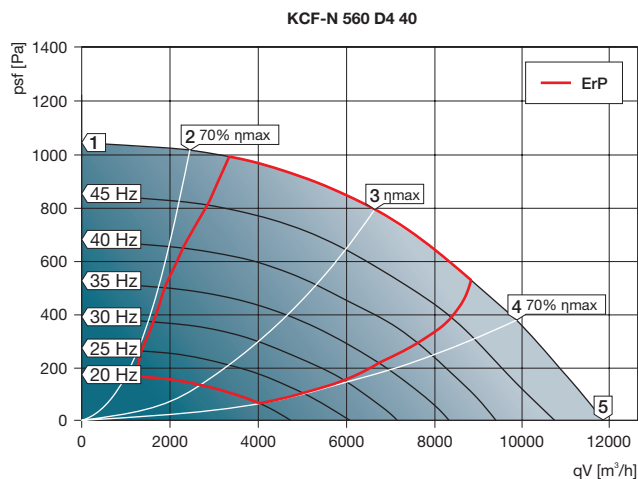
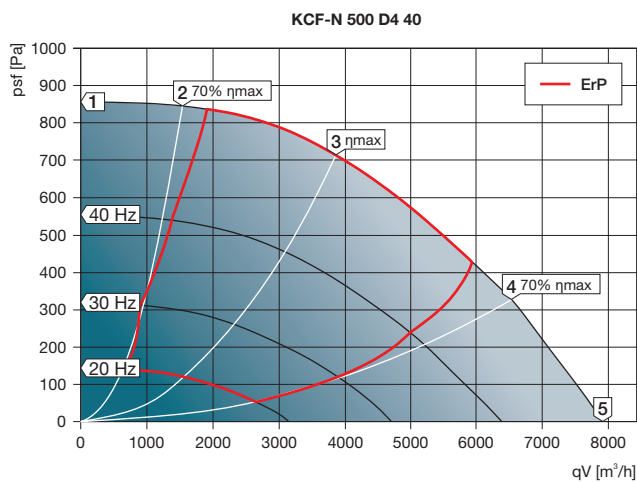
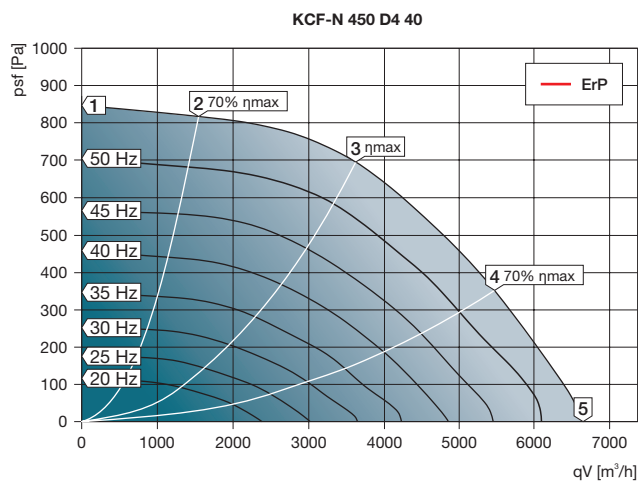
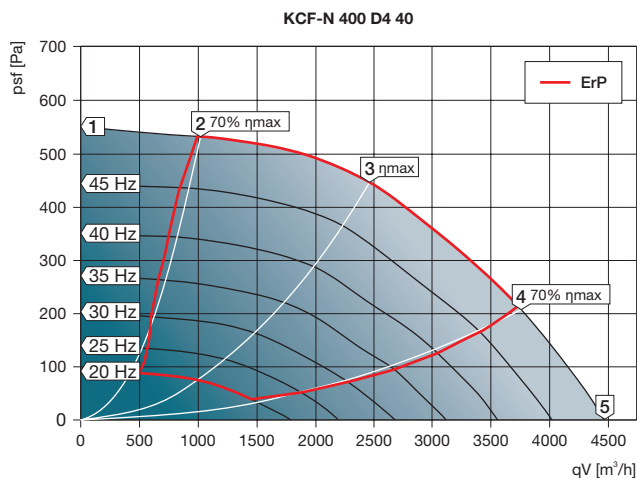
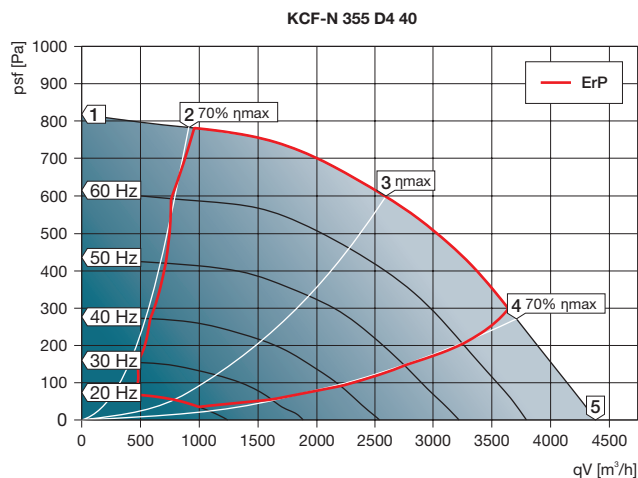

		Технически данни																	
Model KCF-N		225 E2 21	250 E2 20	280 E2 20	315 E2 21	400 E4 21	450 E4 21	500 E4 21	225 D2 40	250 D2 40	280 D2 40	315 D2 40	315 D4 40	355 D4 40	400 D4 40	450 D4 40	500 D4 40	560 D4 40	
Ток	A	1.2	1.9	3.1	5.5	2.3	3.4	6.1	0.9	1.2	1.3	2.3	1.1	1.3	1	2.3	2.7	4.6	
Макс. статична ефективност	%	38.5	51.1	50.3	51.5	45.9	48.5	46.2	46.3	46.4	52.4	57.8	53.5	53.9	53	55.1	53.7	55.6	
Макс. пълна ефективност	%	41.4	56.3	52.9	53.1	49.6	52.6	50	50.6	50	54.8	60.2	56	57.6	56.7	60.9	57.8	58.1	
Макс. позволена честота (3-фазни мотори)	Hz	-	-	-	-	-	-	-	60	60	50	50	80	70	50	55	50	50	
Макс. позволени обороти (с мотори EC)	RPM	-	-	-	-	-	-	-	-	-	-	-	-	-	-	-	-	-	
Макс. консумация на мощност	W	287	448	722	1290	526	849	1505	486	756	759	1221	669	775	564	1278	1504	2577	
Макс. консумация на ток	A	2.3	3.3	4.1	7.6	3	4.7	8.4	0.9	1.3	1.3	2.4	1.2	1.4	1.1	2.5	3	5	
Макс. обороти	RPM	2900	2940	2890	2920	1450	1450	1460	3530	3480	2920	2950	2360	2060	1480	1630	1490	1480	
Макс. въздушен поток	m <sup>3</sup> / h	1460	2490	3400	4450	4250	5780	7800	1960	2730	3350	4520	3580	4350	4450	6660	7890	11840	
Мин. налягане	Pa	-	-	-	-	-	-	-	-	-	-	-	-	-	-	-	-	-	
Макс. налягане	Pa	660	790	980	1260	530	640	815	980	1130	1025	1300	840	820	555	850	855	1050	
Макс. температура на флуида	°C	120	120	120	120	120	120	120	120	120	120	120	120	120	120	120	120	120	
Блокиран ток	A	-	-	-	22	-	-	-	-	-	-	-	-	-	-	-	-	-	
Мин. позволено напрежение	V	110	110	110	110	110	110	110	400	400	400	400	400	400	400	400	400	400	
Тегло	kg	28.4	47.5	47.5	54.5	61.0	76	105	29.3	38	38.5	52.9	52.9	54.7	66.3	74.9	112.7	115	
Шумово ниво L <sub>WA2</sub> (в точка 3 на графиката)	dB (A)	69	71	74	73	62	66	72	74	72	75	72	72	68	66	74	72	76	

**Размери**

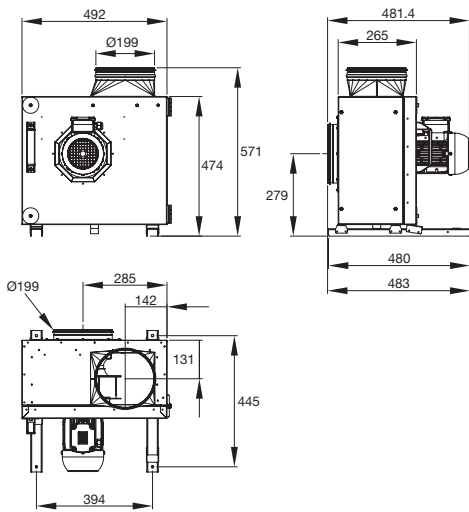

■ KCF-N 225 D2 40

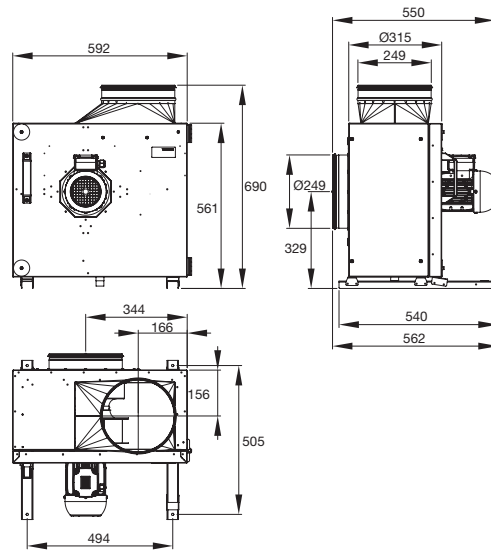

■ KCF-N 250 D2 40

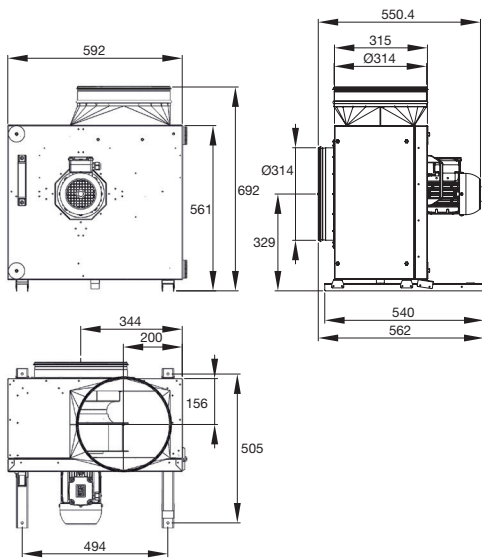

■ KCF-N 280 D2 40

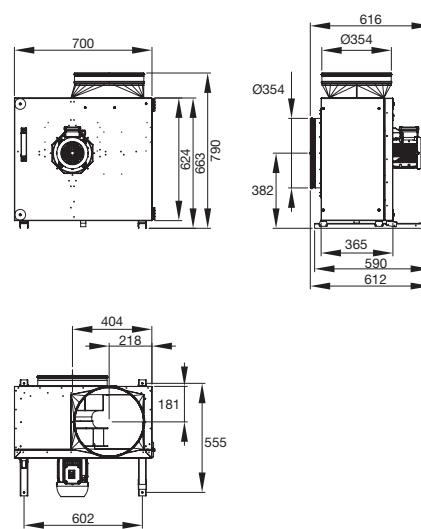

■ KCF-N 315 D2 40

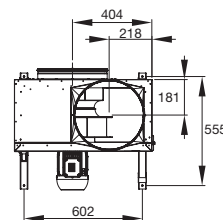
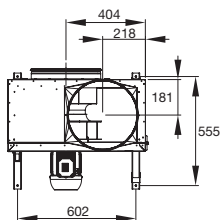
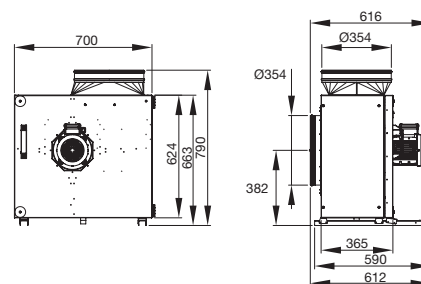
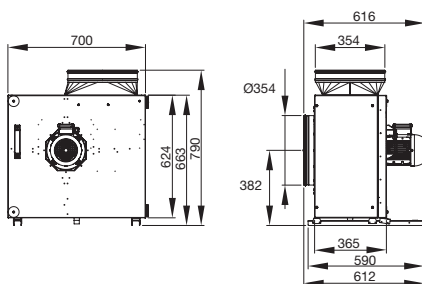

■ KCF-N 315 D4 40

■ KCF-N 355 D4 40

**Размери**



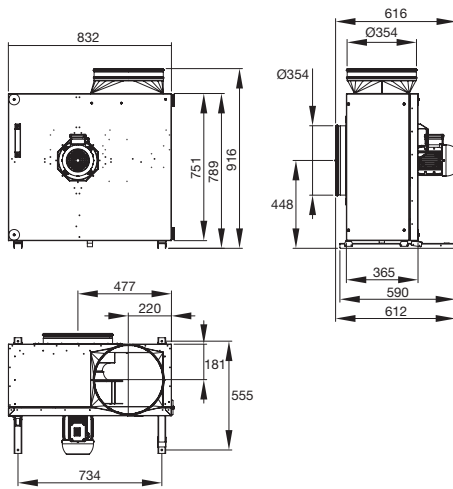

■ KCF-N 400 D4 40

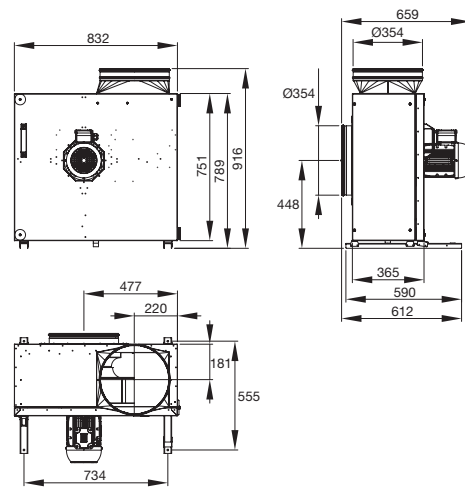

■ KCF-N 450 D4 40

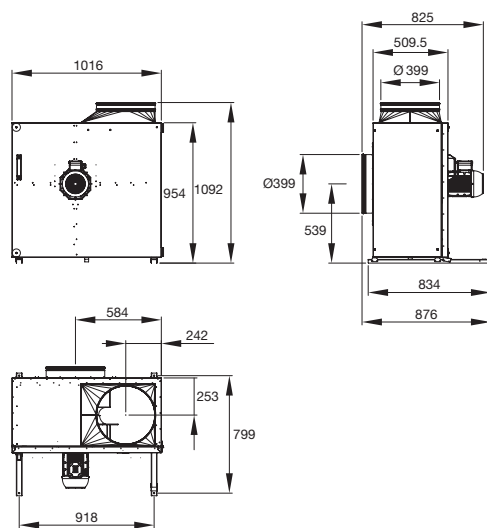

■ KCF-N 500 D4 40

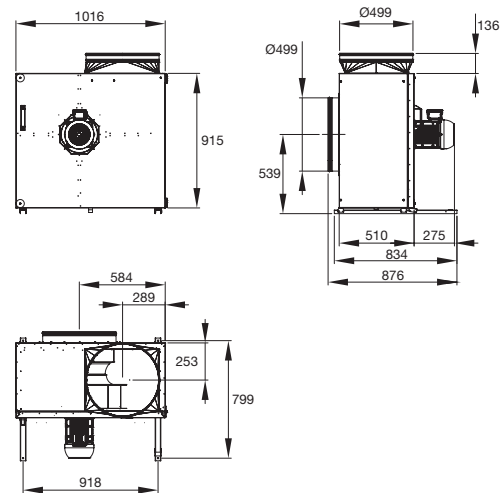

■ KCF-N 560 D4 40

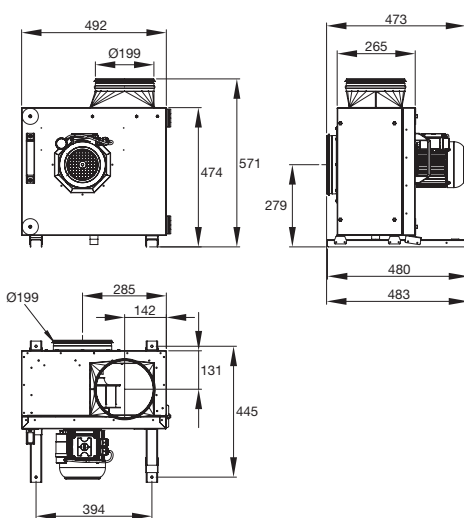

■ KCF-N 225 E2 21

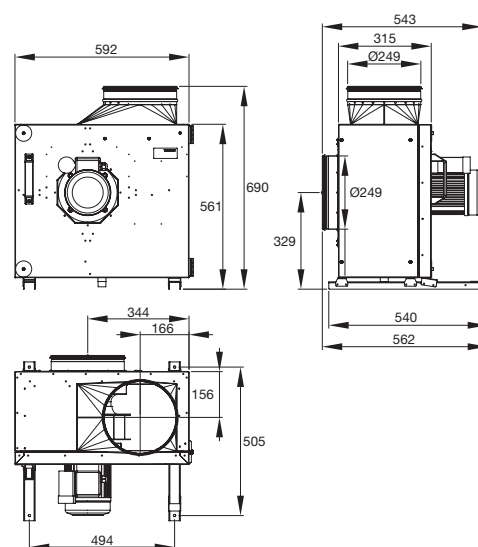

■ KCF-N 250 E2 20

**Размери**

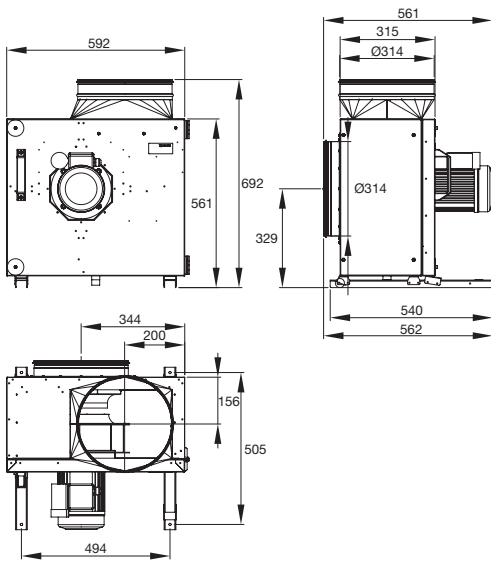

■ KCF-N 280 E2 20

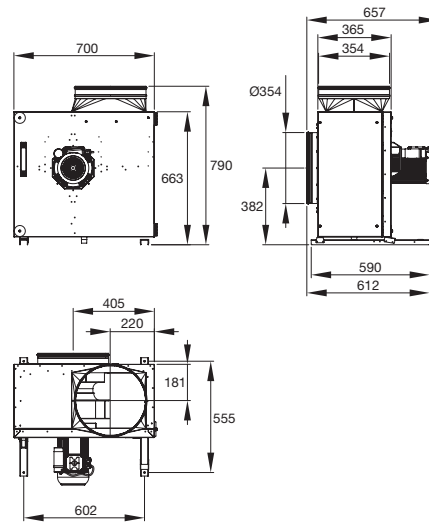

■ KCF-N 315 E2 21

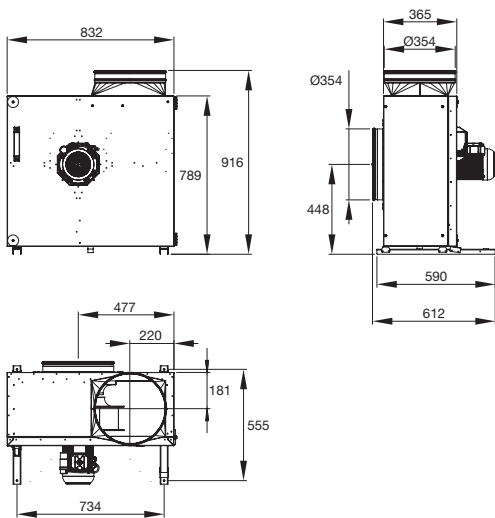

■ KCF-N 400 E2 21

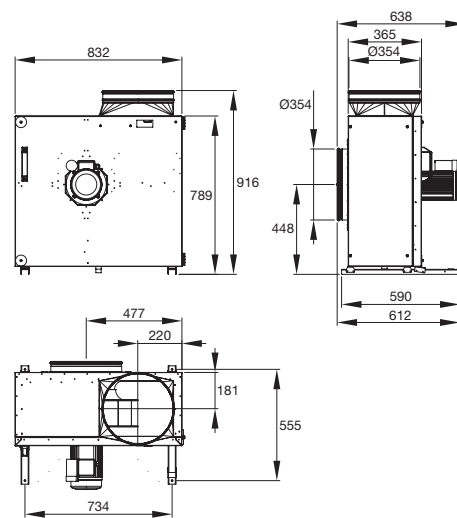

■ KCF-N 450 E2 20

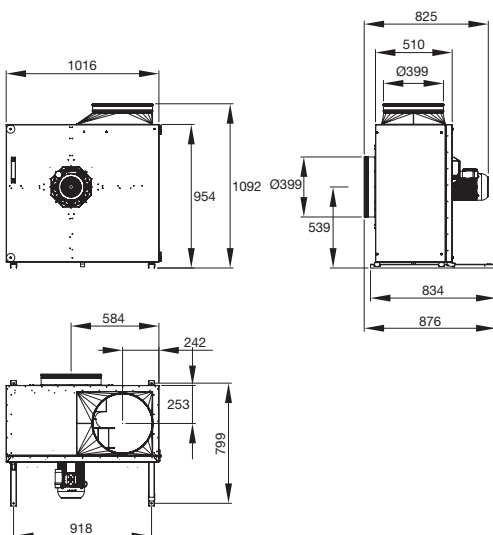

■ KCF-N 500 E2 21