

Центробежен вентилатор с едностранно засмукване тип RL

- Центробежен вентилатор с едностранно засмукване, изнесен двигател и назад обърнати лопатки

Приложение

- Центробежните вентилатори RL са предназначени за пренос на чист или нискозамърсен въздух за индустриални нужди, изискващи голям дебит при високо налягане
- Дебит: **1500 - 270 000 m³/h**
- Свободен напор: **1500 - 11 000 Pa**

Конструкция

- Стоманен корпус, покрит с епоксиден лак, базова рама от стомана
- Импелер с обърнати назад лопатки, динамично и статично балансиран с клас G6.3 в съответствие с ISO 1940/1. Директно куплиран двигател или двигател с ремъчна предавка
- Напълно затворен асинхронен мотор: Клас на защита IP55 – Клас на изолация
- Захранване: 400V, 3ph, 50Hz

Акcesoари

- 5-степенни трансформаторни регулатори на обороти
- Честотни инвертори

Опции

- Стандартно изпълнение - работна температура до 60°C
- Специално изпълнение (SV) - работна температура до 180°C
- Взривозащитено изпълнение, съвместимо с директива ATEX94/9CE

Проектна спецификация

- Центробежен вентилатор с едностранно засмукване, изнесен двигател и импелер с назад обърнати лопатки, модел **RL**

	Мотор	Мощност [kW]	Обороти [RPM]	Шумово ниво [dB(A)]		Мотор	Мощност [kW]	Обороти [RPM]	Шумово ниво [dB(A)]
RL250/2	71	0.55	2850	63	RL800/4	180	22	1460	75
RL280/2	80	1.1	2850	66	RL900/4R	225	37	1470	81
RL310/2	90	2.2	2880	67	RL900/4	225	45	1470	82
RL350/2	100	3	2890	72	RL1000/4R	250	55	1475	77
RL400/2R	112	4	2950	70	RL1000/4	280	75	1480	85
RL400/2	132	5.5	2950	76	RL500/6R	80	0.37	930	50
RL450/2R	132	7.5	2950	79	RL500/6	80	0.55	930	56
RL450/2	160	11	2955	82	RL560/6R	90	0.75	930	60
RL500/2R	160	15	2960	80	RL560/6	90	1.1	930	61
RL500/2	160	18.5	2960	82	RL630/6R	100	1.5	940	63
RL310/4	63	0.18	1350	52	RL630/6	112	2.2	950	64
RL350/4	71	0.37	1370	57	RL710/6R	132	3	950	64
RL400/4R	80	0.55	1395	59	RL710/6	132	4	960	68
RL400/4	80	0.75	1400	60	RL800/6R	132	5.5	960	70
RL450/4R	80	0.75	1400	59	RL800/6	160	7.5	960	71
RL450/4	90	1.1	1415	60	RL900/6R	160	11	970	73
RL500/4R	90	1.5	1420	67	RL900/6	180	15	970	74
RL500/4	100	2.2	1440	69	RL1000/6R	200	18.5	975	75
RL560/4R	100	3	1440	70	RL1000/6	200	22	975	76
RL560/4	112	4	1450	72	RL1120/6R	225	30	975	78
RL630/4R	132	5.5	1455	73	RL1120/6	250	37	980	78
RL630/4	132	7.5	1455	73	RL1250/6R	280	55	985	81
RL710/4R	160	11	1460	74	RL1250/6	315	75	985	82
RL710/4	160	15	1460	78	RL1400/6R	315	90	985	82
RL800/4R	180	18.5	1460	79	RL1400/6	315	110	985	84

Селекция

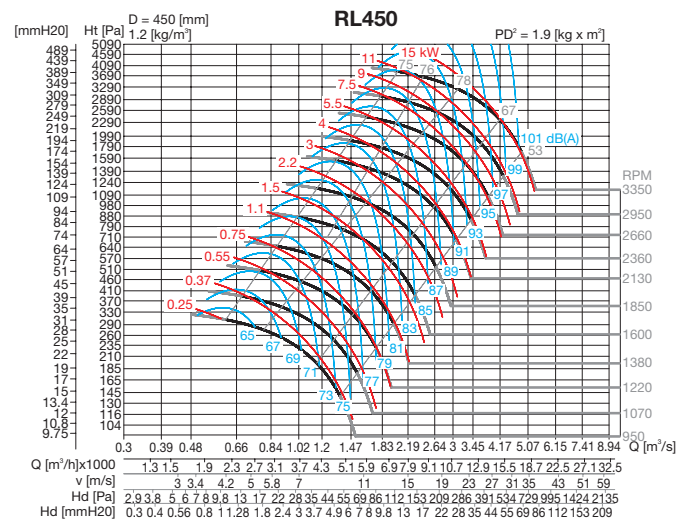
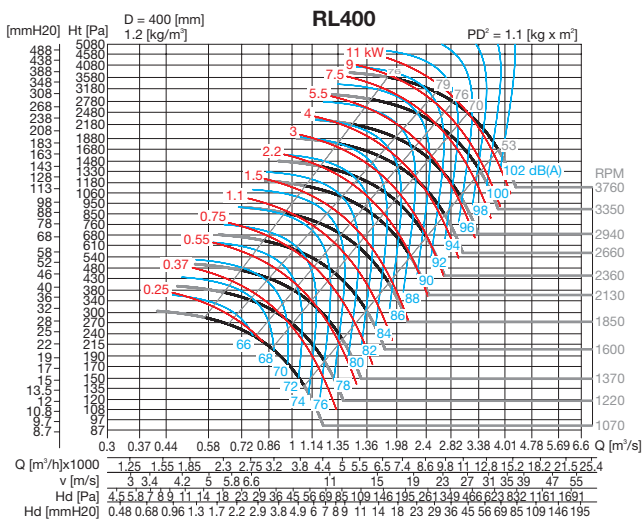
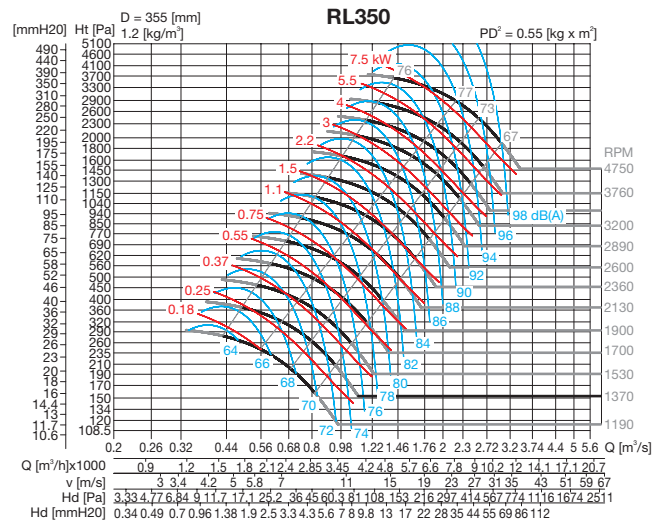
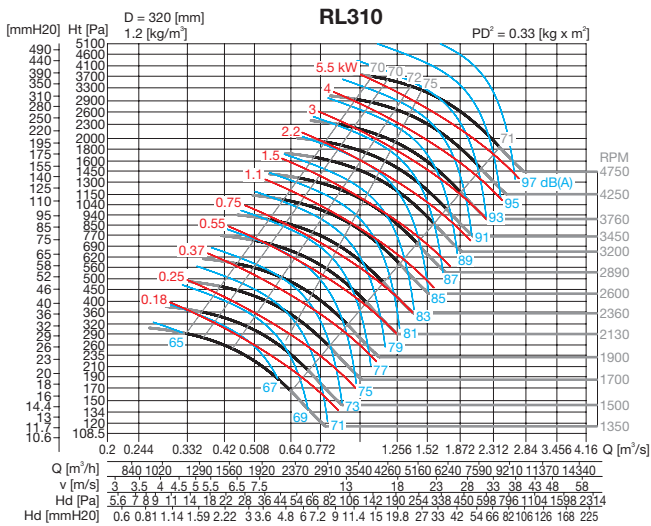
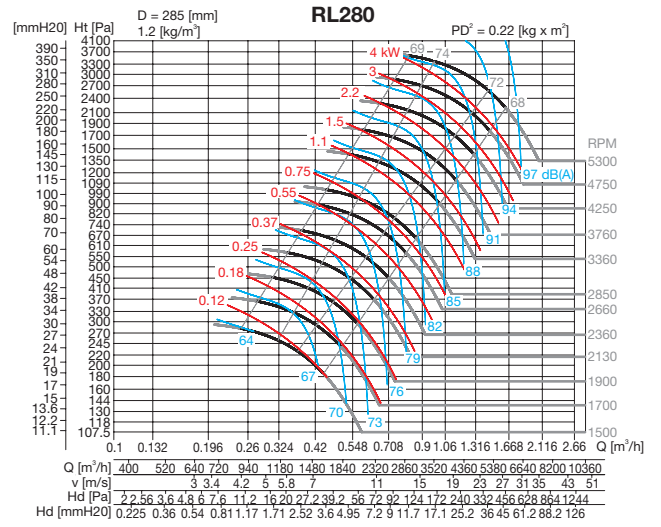
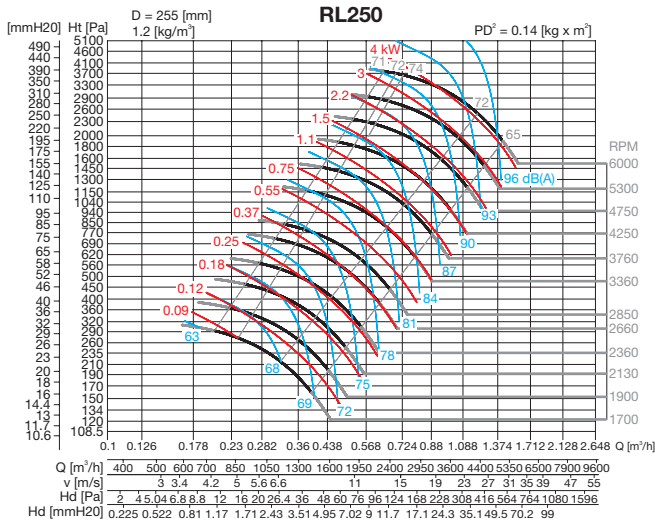

Селекция

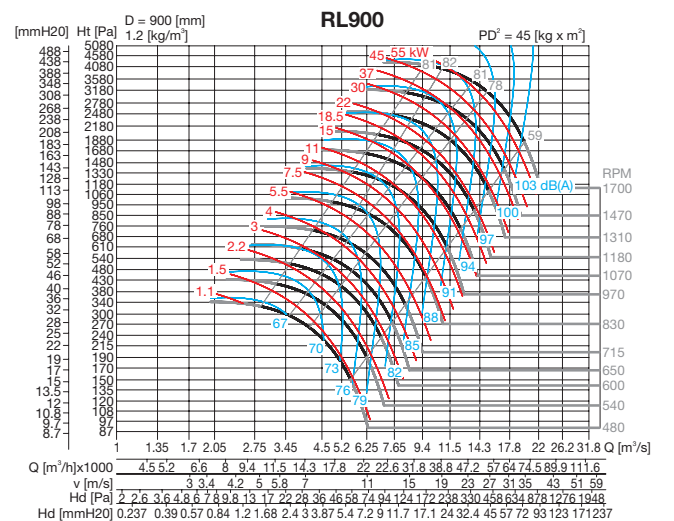
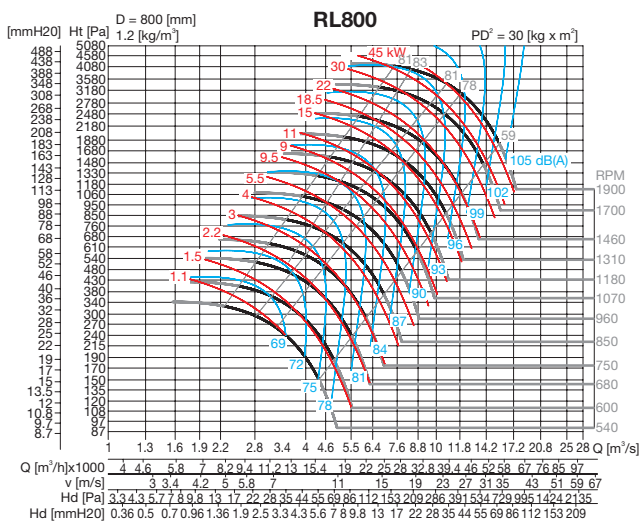
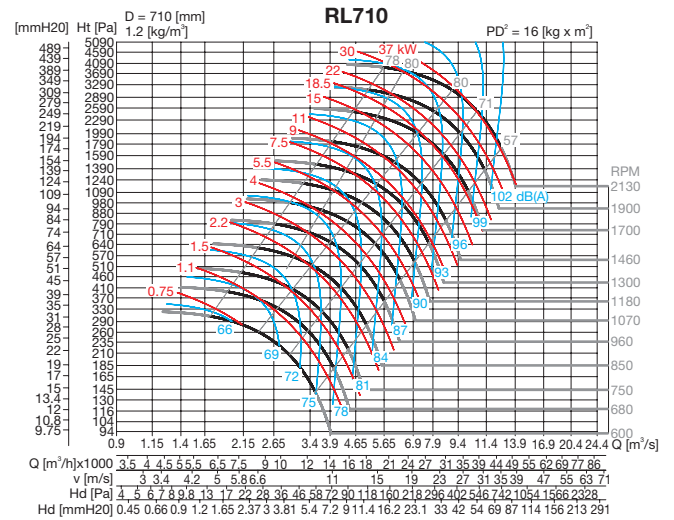
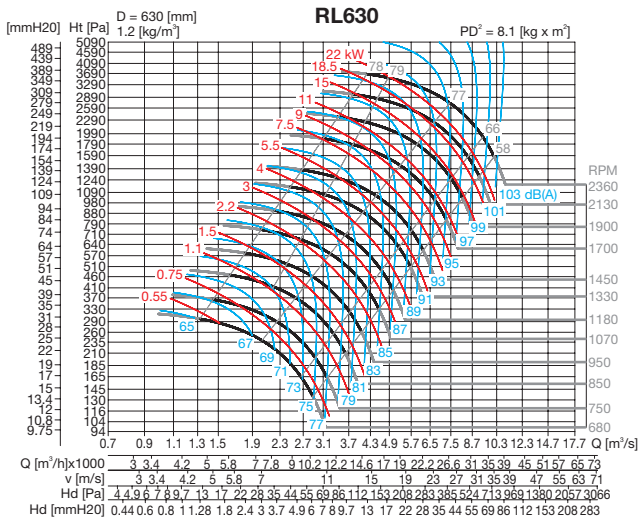
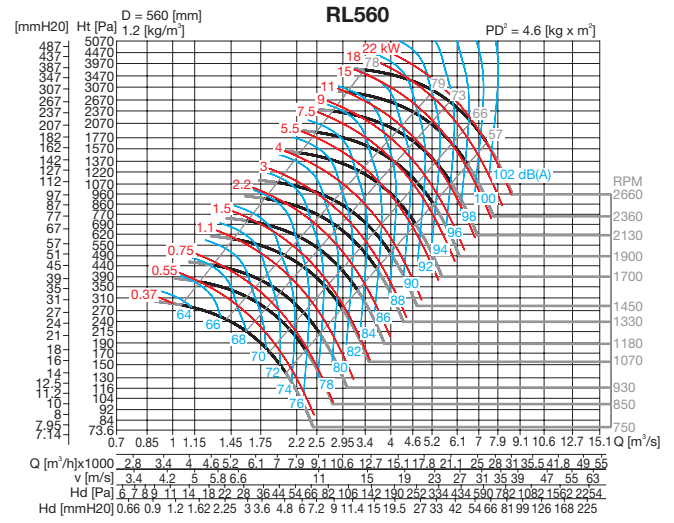
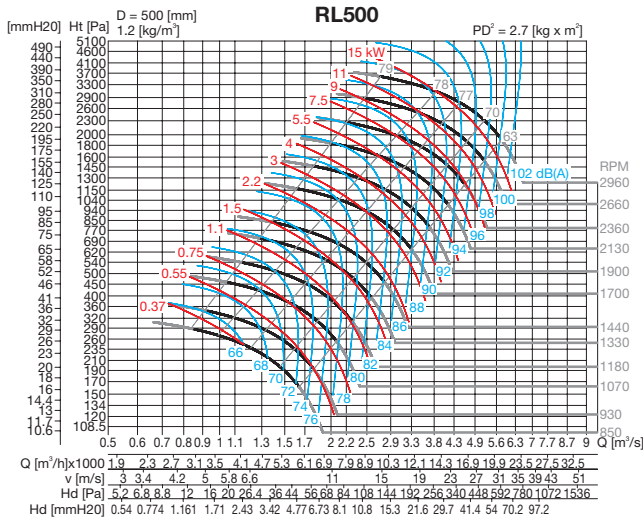

Селекция

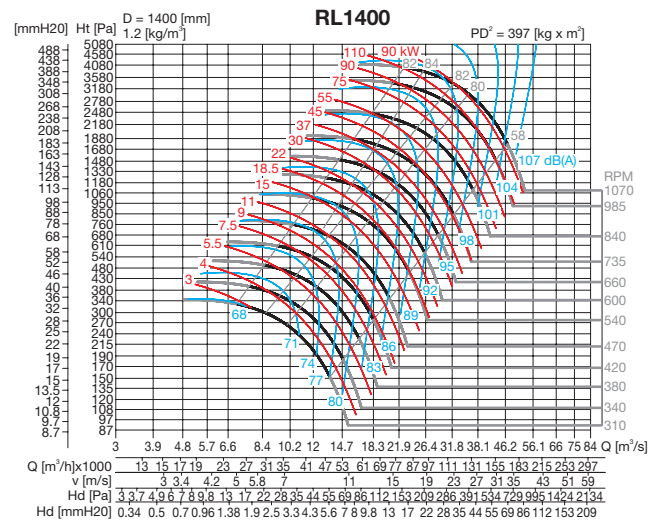
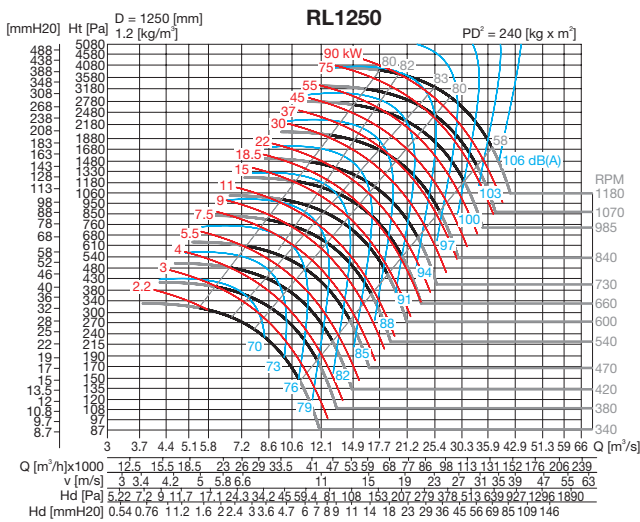
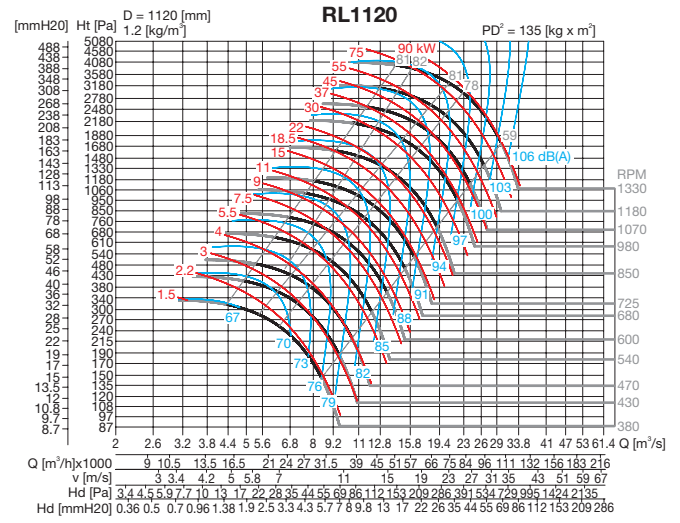
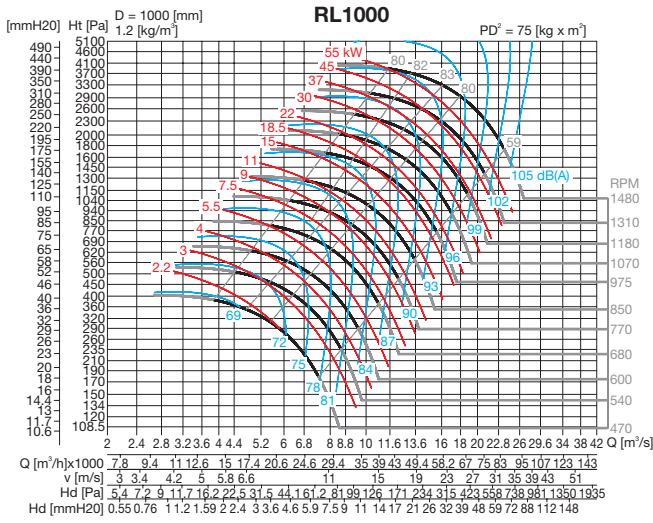

Забележки

- Q = дебит
- v = скорост
- Hd = динамично налягане
- Pt = пълен напор

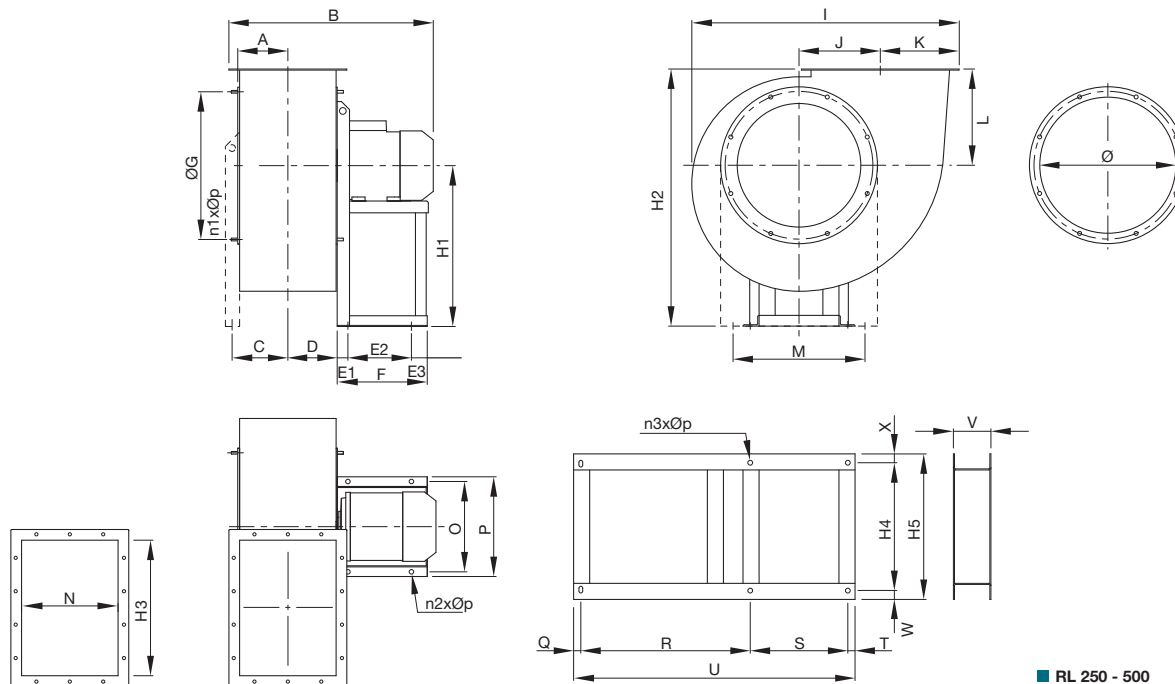

■ RL 250 - 500



Размери																				
	A	B	C	D	E1	E2	E3	F	ØG	H1	H2	H3	H4	H5	I	J	K	L		
	[mm]	[mm]	[mm]	[mm]	[mm]	[mm]	[mm]	[mm]	[mm]	[mm]	[mm]	[mm]	[mm]	[mm]	[mm]	[mm]	[mm]	[mm]	[mm]	
RL250/2	94	434	110	96	49	121	26	196	Ø292	315	510	258	210	244	525	149	164	195		
RL280/2	105	482	123	105	48	121	48	217	Ø332	375	575	288	284	330	586	172	184	200		
RL310/2	117	553	135	117	55	133	58	246	Ø366	400	625	322	284	330	653	196	201	225		
RL310/4	117	452	135	117	45	86	14	145	Ø366	400	625	322	284	330	653	196	201	225		
RL350/2	130	611	153	131	30	197	49	276	Ø405	450	705	361	407	463	725	216	221	225		
RL350/4	130	509	153	131	45	121	23	189	Ø405	450	705	361	407	463	725	216	221	225		
RL400/2R	147	664	174	147	30	197	49	276	Ø448	500	785	404	407	463	798	245	242	285		
RL400/2	147	704	174	147	40	237	59	336	Ø448	500	785	404	407	463	798	245	242	285		
RL400/4R	147	565	174	147	45	121	45	211	Ø448	500	785	404	407	463	798	245	242	285		
RL400/4	147	565	174	147	45	121	45	211	Ø448	500	785	404	407	463	798	245	242	285		
RL450/2R	163	739	191	165	40	237	59	336	Ø497	560	880	453	407	463	895	275	267	320		
RL450/2	163	844	191	165	50	337	49	436	Ø497	560	880	453	407	463	895	275	267	320		
RL450/4R	163	600	191	165	45	121	45	211	Ø497	560	880	453	407	463	895	275	267	320		
RL450/4	163	647	191	165	55	133	58	246	Ø497	560	880	453	407	463	895	275	267	320		
RL500/2R	183	884	211	185	50	337	49	436	Ø551	600	960	507	407	463	997	303	294	360		
RL500/2	183	884	211	185	50	337	49	436	Ø551	600	960	507	407	463	997	303	294	360		
RL5000/4R	183	687	211	185	55	133	58	246	Ø551	600	960	507	407	463	997	303	294	360		
RL500/4	183	718	211	185	30	197	49	276	Ø551	600	960	507	407	463	997	303	294	360		
RL5000/6R	183	640	211	185	45	121	45	211	Ø551	600	960	507	407	463	997	303	294	360		
RL500/6	183	640	211	185	45	121	45	211	Ø551	600	960	507	407	463	997	303	294	360		
	M	N	O	P	Q	R	S	T	U	V	W	X	n1xØp	n2xØp	n3xØp	Ø				
	[mm]	[mm]	[mm]	[mm]	[mm]	[mm]	[mm]	[mm]	[mm]	[mm]	[mm]	[mm]	[mm]	[mm]	[mm]	[mm]	[mm]	[mm]	[mm]	[kg]
RL250/2	280	185	203	225	13.5	445	228	13.5	700	80	17	17	n8 M6 x Ø20	n4 x Ø10	n6 x Ø12	Ø255			37	
RL280/2	315	205	203	225	18	576	288	18	900	100	23	23	n8 M6 x Ø20	n4 x Ø10	n6 x Ø15	Ø285			45	
RL310/2	350	229	234	260	18	576	288	18	900	100	23	23	n8 M6 x Ø20	n4 x Ø10	n6 x Ø15	Ø320			57	
RL310/4	350	229	184	206	18	576	288	18	900	100	23	23	n8 M6 x Ø20	n4 x Ø10	n6 x Ø15	Ø320			43	
RL350/2	395	256	289	324	23	610	355	23	1010	120	28	28	n8 M8 x Ø25	n4 x Ø12	n6 x Ø15	Ø360			80	
RL350/4	395	256	203	225	23	610	355	23	1010	120	28	28	n8 M8 x Ø25	n4 x Ø10	n6 x Ø15	Ø360			65	
RL400/2R	445	288	289	324	23	610	355	23	1010	120	28	28	n8 M8 x Ø25	n4 x Ø12	n6 x Ø15	Ø405			95	
RL400/2	445	288	337	372	23	610	355	23	1010	120	28	28	n8 M8 x Ø25	n4 x Ø12	n6 x Ø15	Ø405			116	
RL400/4R	445	288	203	225	23	610	355	23	1010	120	28	28	n8 M8 x Ø25	n4 x Ø10	n6 x Ø15	Ø405			75	
RL400/4	445	288	203	225	23	610	355	23	1010	120	28	28	n8 M8 x Ø25	n4 x Ø10	n6 x Ø15	Ø405			75	
RL450/2R	495	322	337	372	23	610	355	23	1010	120	28	28	n8 M8 x Ø25	n4 x Ø12	n6 x Ø15	Ø455			124	
RL450/2	495	322	395	440	23	610	355	23	1010	120	28	28	n8 M8 x Ø25	n4 x Ø14	n6 x Ø15	Ø455			161	
RL450/4R	495	322	203	225	23	610	355	23	1010	120	28	28	n8 M8 x Ø25	n4 x Ø10	n6 x Ø15	Ø455			89	
RL450/4	495	322	234	260	23	610	355	23	1010	120	28	28	n8 M8 x Ø25	n4 x Ø10	n6 x Ø15	Ø455			94	
RL500/2R	545	361	395	440	27	632	364	27	1050	140	33	33	n8 M10 x Ø30	n4 x Ø14	n6 x Ø18	Ø551			187	
RL500/2	545	361	395	440	27	632	364	27	1050	140	33	33	n8 M10 x Ø30	n4 x Ø14	n6 x Ø18	Ø551			196	
RL5000/4R	545	361	234	260	27	632	364	27	1050	140	33	33	n8 M10 x Ø30	n4 x Ø10	n6 x Ø18	Ø551			123	
RL500/4	545	361	289	324	27	632	364	27	1050	140	33	33	n8 M10 x Ø30	n4 x Ø12	n6 x Ø18	Ø551			130	
RL5000/6R	545	361	203	225	27	632	364	27	1050	140	33	33	n8 M10 x Ø30	n4 x Ø10	n6 x Ø18	Ø551			115	
RL500/6	545	361	203	225	27	632	364	27	1050	140	33	33	n8 M10 x Ø30	n4 x Ø10	n6 x Ø18	Ø551			117	

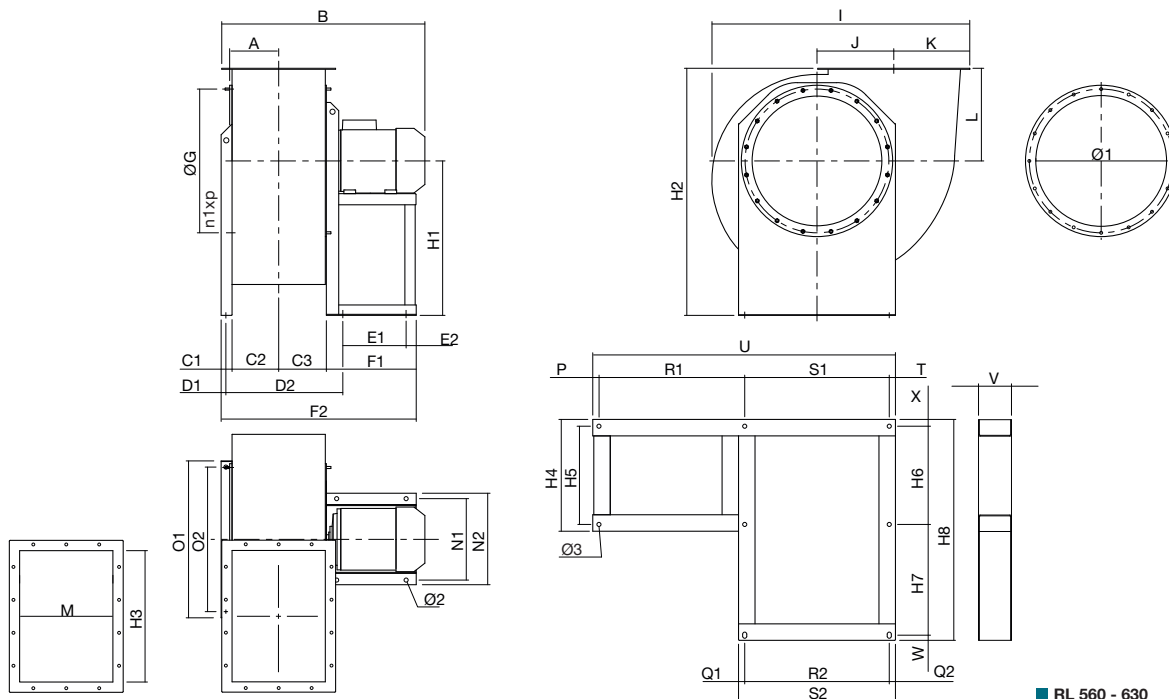

Размери																							
	A	B	C1	C2	C3	D1	D2	E1	E2	F1	F2	ØG	H1	H2	H3	H4	H5	H6	H7	H8	I	J	K
	[mm]	[mm]	[mm]	[mm]	[mm]	[mm]	[mm]	[mm]	[mm]	[mm]	[mm]	[mm]	[mm]	[mm]	[mm]	[mm]	[mm]	[mm]	[mm]	[mm]	[mm]	[mm]	[mm]
RL560/4R	205	774	53	202	207	23	468	197	49	275	737	Ø629	670	1070	569	543	477	477	488	1021	1151	332	335
RL560/4	205	765	53	202	207	23	468	197	49	275	737	Ø629	670	1070	569	543	477	477	488	1021	1151	332	335
RL560/6R	205	743	53	202	207	23	493	133	58	245	707	Ø629	670	1070	569	543	477	477	488	1021	1151	332	335
RL560/6	205	743	53	202	207	23	493	133	58	245	707	Ø629	670	1070	569	543	477	477	488	1021	1151	332	335
RL630/4R	230	885	53	227	232	23	527	237	59	335	846	Ø698	750	1200	638	543	477	477	488	1070	1282	373	369
RL630/4	230	885	53	227	232	23	527	237	59	335	846	Ø698	750	1200	638	543	477	477	488	1070	1282	373	369
RL630/6R	230	824	53	227	232	23	517	197	49	275	786	Ø698	750	1200	638	543	477	477	488	1070	1282	373	369
RL630/6	230	824	53	227	232	23	517	197	49	275	786	Ø698	750	1200	638	543	477	477	488	1070	1282	373	369
	L	M	N1	N2	O1	O2	P	Q1	Q2	R1	R2	S1	S2	T	U	V	W	X	n1xØp	Ø1	Ø2	Ø3	kg
	[mm]	[mm]	[mm]	[mm]	[mm]	[mm]	[mm]	[mm]	[mm]	[mm]	[mm]	[mm]	[mm]	[mm]	[mm]	[mm]	[mm]	[mm]	[mm]	[mm]	[mm]	[mm]	[mm]
RL560/4R	400	404	289	324	692	632	30	30	30	678	632	632	692	30	1370	160	23	33	n16 M10 x Ø30	Ø565	Ø12	Ø18	153
RL560/4	400	404	289	324	692	632	30	30	30	678	632	632	692	30	1370	160	23	33	n16 M10 x Ø30	Ø565	Ø12	Ø18	158
RL560/6R	400	404	234	260	692	632	30	30	30	678	632	632	692	30	1370	160	23	33	n16 M10 x Ø30	Ø565	Ø12	Ø18	141
RL560/6	400	404	234	260	692	632	30	30	30	678	632	632	692	30	1370	160	23	33	n16 M10 x Ø30	Ø565	Ø12	Ø18	145
RL630/4R	450	453	337	372	762	702	30	30	30	708	702	702	762	30	1470	160	23	33	n16 M10 x Ø30	Ø631	Ø12	Ø18	202
RL630/4	450	453	337	372	762	702	30	30	30	708	702	702	762	30	1470	160	23	33	n16 M10 x Ø30	Ø631	Ø12	Ø18	214
RL630/6R	450	453	289	324	762	702	30	30	30	708	702	702	762	30	1470	160	23	33	n16 M10 x Ø30	Ø631	Ø12	Ø18	173
RL630/6	450	453	289	324	762	702	30	30	30	708	702	702	762	30	1470	160	23	33	n16 M10 x Ø30	Ø631	Ø12	Ø18	180

